

## **RSL 642**

### Single Point Aluminium Load Cell

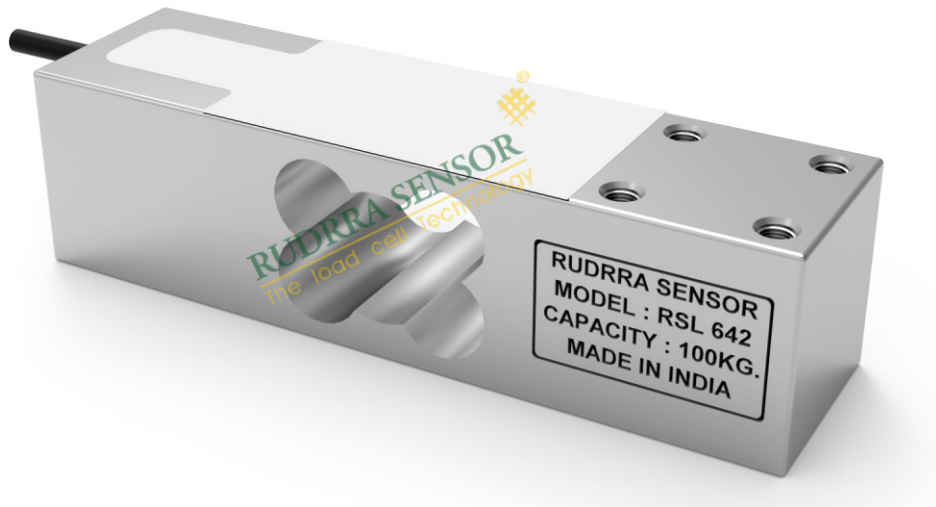

#### Product Description

We have a wide range of Aluminium Load Cell RSL 642 in our store which is manufactured using high grade raw material. It is available in our organization. Our product is used in various industries for various applications. Our product can be customized as per our customer's special need and requirements. We are always demanded in the domestic as well as international market due to our world class customer services and product quality.

#### Applications

- \* Bench, Counting & Postal Scales
- \* Check Weighers(Recommended platform size : 400x400mm)

#### Key Features

- \* Single Point Off-center Load Measuring Capability
- \* Economical and Low Profile Cell
- \* Aluminium-alloy, Colorless anodized
- \* Glue sealed

#### Optional :

- \* Digital Load cell
- \* Stainless steel structure



# RSL 642

## Single Point Aluminium Load Cell

**RUDRRA SENSOR**  
The load cell Technology

Load Application Layout :

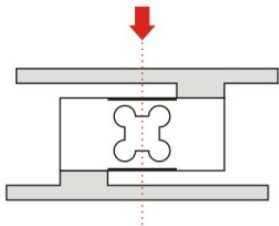

Dimensions :

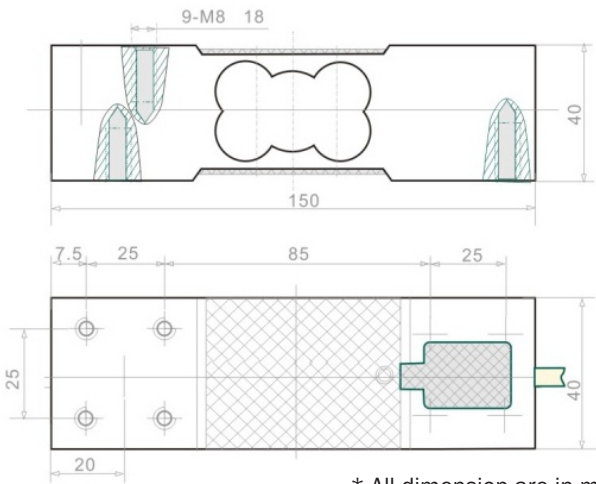

\* All dimension are in mm

Cable Connection Details :

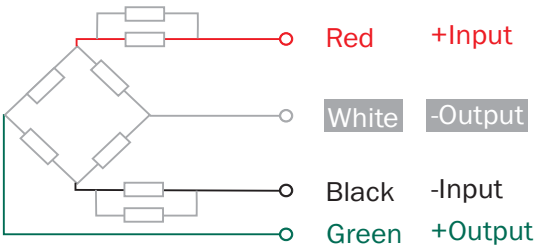

### Parameters : (Analog Load Cell)

Related Load (kg.) 100 / 200 / 300 / 500			
Precision	C3	Insulation Resistance(MΩ)	≥ 5000(100VDC)
Composition Error	0.02	Excitation Voltage (V)	5~12 (DC)
Rated Output (mv/v)	2 ± 0.2	Compensated temp. Range ( °C)	-10~+40
Non-Linearity (%FS)	0.017	Use Temp. Range ( °C)	-35~+65
Hysteresis (%FS)	0.02	Temp. Effect on Zero (%FS/10 °C)	0.017
Repeatability (%FS)	0.01	Temp. Effect on Span (%FS/10 °C)	0.017
Creep (%FS/30min)	0.02	Safe Overload (%FS)	120
Zero Balance (%FS)	± 1	Ultimate Overload (%FS)	150
Input Resistance (Ω)	400 ± 10	Defend Grade	IP67
Output Resistance (Ω)	350 ± 2	Cable	4mm, 3mtr

