

## Model : RSL 203

### PANCAKE LOAD CELL (TESTING MACHINE LOAD CELL)



#### Features :

- \* Alloy steel & Stainless Steel structure;
- \* Nickel plated
- \* Suitable for multiform environments
- \* Easy to install & use

#### Applications :

- \* Electronic Truck Scale
- \* Truck Scales, Hooper Scale
- \* Other Electronic Weighing Devices (UTM)
- \* In Motion Weighing Application

#### Parameters :

Related Load (Ton) 0.2, 0.5, 1, 2, 3, 5, 10, 20, 30, 50, 100, 150, 200			
Precision	C2	Insulation Resistance(MΩ)	≥20000 (50VDC)
Composition Error	±0.03	Excitation Voltage (V)	5~12 (DC)
Rated Output (mv/v)	2±0.008	Compensated temp. Range (°C)	-10~+40
Non-Linearity (%FS)	0.017	Use Temp. Range	-20~+55 °C
Hysteresis (%FS)	0.02	Temp. Effect on Zero (%FS/10°C)	0.05
Repeatability(%FS)	0.01	Temp. Effect on Span (%FS/10°C)	0.03
Creep (%FS/30min)	0.03	Safe Overload (%FS)	150
Zero Balance(%FS)	±1	Ultimate Overload (%FS)	200
Input Resistance (Ω)	750 ± 10	Defend Grade	IP67
output Resistance (Ω)	700 ± 5	Cable	6mm, 10mtr.

#### Wiring Schematic Diagram :

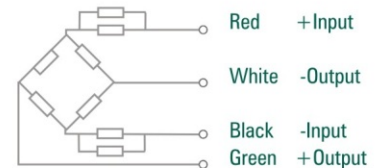

#### Load Diagram :

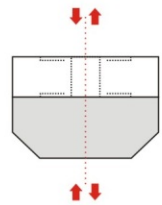

#### Dimensions :

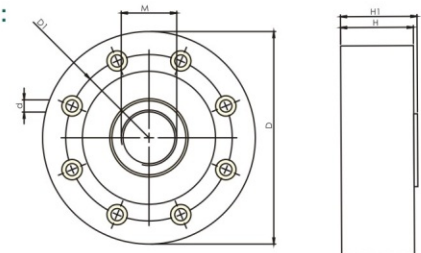

Max. Cap	D	D1	d	M	H	H1
200kg to 5000kg	105	90	6.5x8	M16X1.5	32	36
10000kg & 15000kg	115	90	10.5x8	M30X2.0	40	42
20T to 30T	155	125	16.5x8	M39X2.0	50	52
50T	205	165	16.5x8	M48X2.0	60	65
100T	280	222	20.5x8	M72X2.0	90	95

